

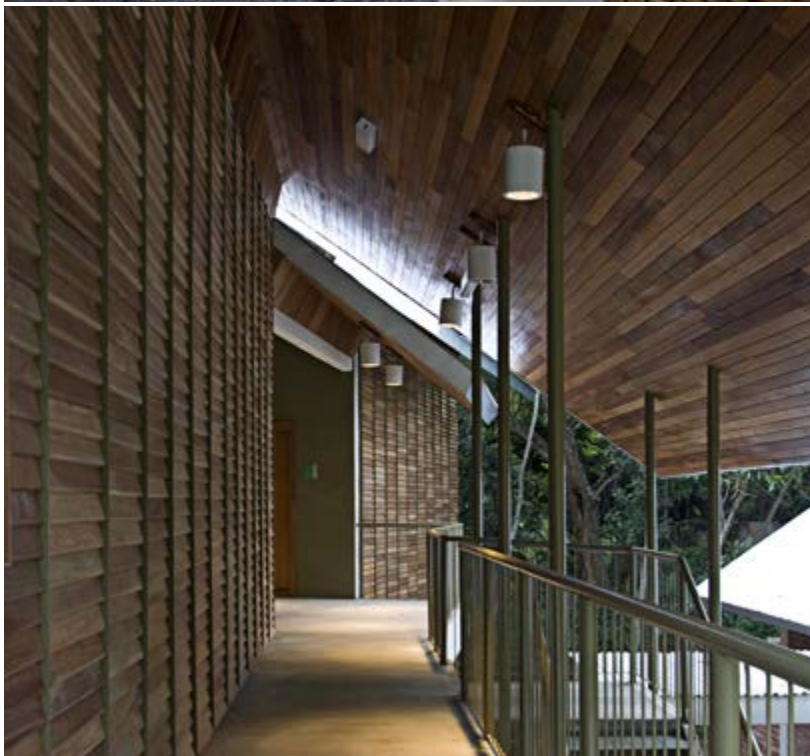

PULAU BANDING
RAINFOREST
RESEARCH CENTRE



**Pulau Banding Rainforest
Research Centre**
Royal Belum, Malaysia
2007 - 2008

This is a small complex comprising two laboratories, library, office and open terraces for sitting and sleeping. It was designed as a place to facilitate the gathering and the dissemination of information from the jungles in Royal Belum and Temenggor Dam Complex in line with ideas of sustainability outlined in the 'Pulau Banding Charter'.

It incorporates environmentally friendly and tropical themes such as a safari roofs, deep roof overhangs, open terraces, open yards and toilets. Existing trees on the site were retained. Researchers are encouraged to cultivate a garden of indigenous trees from saplings collected in the jungle.

MKN Group Sdn. Bhd.
RM 0.65 mil
286 sq.m

PAM Awards 2008
Public & Civic Building
Mention

M&E Consultant
Norman & Young Sdn Bhd
C&S Consultant
KAL & Partners Sdn Bhd
QS Consultant
Juru Ukur Bahan (M) Sdn Bhd
Landscape
Distinct Acres Group Companies
Main Contractor
Juteras Sdn Bhd

“ Recycled features like timber slatted walls are appropriate to the ethos of the centre. ”

Jennifer Choo
 Writer of Depth of Details
 ROOM: Foray, Issue 4
 July - August 2010

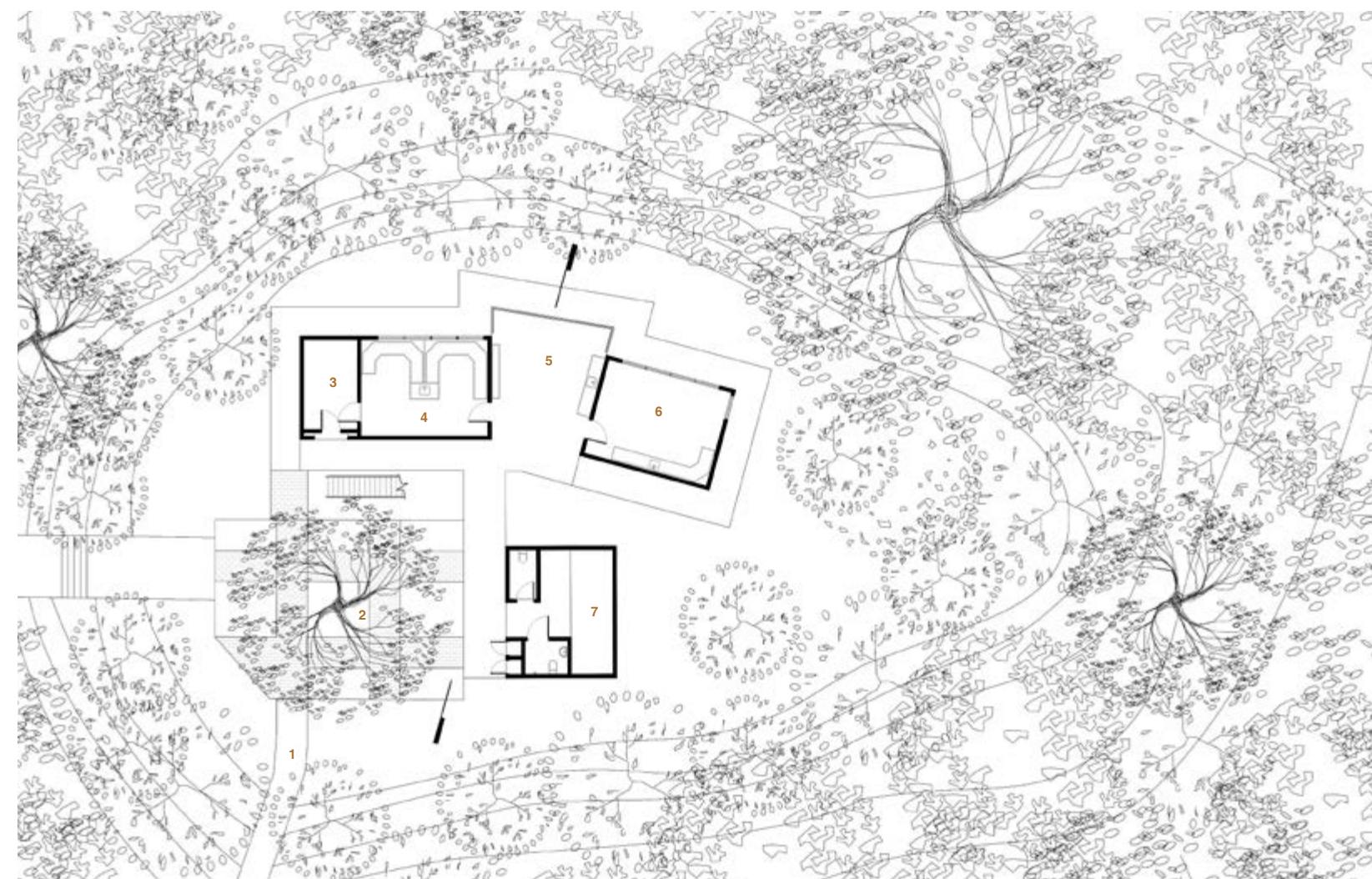

- 1 Entrance
- 2 Forecourt
- 3 Archive
- 4 Dry Lab
- 5 Pantry
- 6 Wet Lab
- 7 Toilets



South Elevation

Site Section